

MALE ELBOW CONNECTOR (SLW Type)

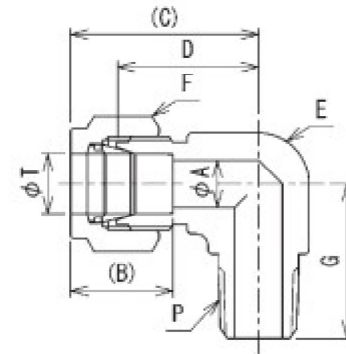

UNIT : mm

型番	チューブ外径	管用テーパ おねじ	最小穴径	差込深さ	粗込長さ	本体長さ	二面幅	六角対辺	
TYPE NO.	TUBE O.D.	PIPE THREAD	MIN. BORE	DEPTH	APPROX	BODY	WIDTH ACROSS FLATS	WIDTH ACROSS HEX	
	T	P	A	B	C	D	E	F	G

[インチサイズチューブ用] チューブ外径の () 内はインチサイズ表示

SLW- 1C- 2R	1.58(1/16")	R1/8	1.4	8.3	20.2	16.4	12.7	8	18.8
SLW- 2C- 2R	3.17(1/8")	R1/8	2.4	13	24.7	18.0	12.7	12	18.8
SLW- 2C- 4R	3.17(1/8")	R1/4	2.4	13	24.7	18.0	12.7	12	23.4
SLW- 3C- 2R	4.76(3/16")	R1/8	3.2	13.7	25.6	18.9	12.7	14	18.8
SLW- 3C- 4R	4.76(3/16")	R1/4	3.2	13.7	25.6	18.9	12.7	14	23.4
SLW- 4C- 2R	6.35(1/4")	R1/8	4.8	15.6	27.2	19.6	12.7	14	18.8
SLW- 4C- 4R	6.35(1/4")	R1/4	4.8	15.6	27.2	19.6	12.7	14	23.4
SLW- 4C- 6R	6.35(1/4")	R3/8	4.8	15.6	30	22.4	17.5	14	26.2
SLW- 4C- 8R	6.35(1/4")	R1/2	4.8	15.6	32	24.4	20.6	14	33
SLW- 6C- 2R	9.52(3/8")	R1/8	5	17.2	30.8	23.1	15.9	17.4	20.8
SLW- 6C- 4R	9.52(3/8")	R1/4	7.5	17.2	30.8	23.1	15.9	17.4	25.4
SLW- 6C- 6R	9.52(3/8")	R3/8	7.5	17.2	31.6	23.9	17.5	17.4	26.2
SLW- 6C- 8R	9.52(3/8")	R1/2	7.5	17.2	33.6	25.9	20.6	17.4	33
SLW- 8C- 2R	12.7(1/2")	R1/8	5	23.1	36.3	25.9	20.6	22	23.6
SLW- 8C- 4R	12.7(1/2")	R1/4	7.5	23.1	36.3	25.9	20.6	22	28.2
SLW- 8C- 6R	12.7(1/2")	R3/8	10	23.1	36.3	25.9	20.6	22	28.2
SLW- 8C- 8R	12.7(1/2")	R1/2	10.4	23.1	36.3	25.9	20.6	22	33
SLW-10C- 6R	15.88(5/8")	R3/8	10	24.9	37.6	27	24	27	29
SLW-10C- 8R	15.88(5/8")	R1/2	12	24.9	37.6	27	24	27	34.1
SLW-10C-12R	15.88(5/8")	R3/4	13	24.9	40.6	30	30	27	37.1
SLW-12C- 8R	19.05(3/4")	R1/2	12	24.9	40.6	30	30	30	37.1
SLW-12C-12R	19.05(3/4")	R3/4	16	24.9	40.6	30	30	30	37.1
SLW-14C- 8R	22.23(7/8")	R1/2	12	26.6	40.6	30	30	32	37.1
SLW-14C-12R	22.23(7/8")	R3/4	16	26.6	40.6	30	30	32	37.1
SLW-16C- 8R	25.4(1")	R1/2	12	31.7	46.9	34.2	35	38	39.1
SLW-16C-12R	25.4(1")	R3/4	16	31.7	46.9	34.2	35	38	39.1
SLW-16C-16R	25.4(1")	R1	22.3	31.7	46.9	34.2	35	38	43.9